

42° 11' N W  
(BROADVIEW)

UNITED STATES  
DEPARTMENT OF THE INTERIOR  
GEOLOGICAL SURVEY

BROADVIEW EAST QUADRANGLE  
MONTANA-YELLOWSTONE CO.  
7.5 MINUTE SERIES (TOPOGRAPHIC)

42° 11' N W  
(HAY BASIN NORTH)

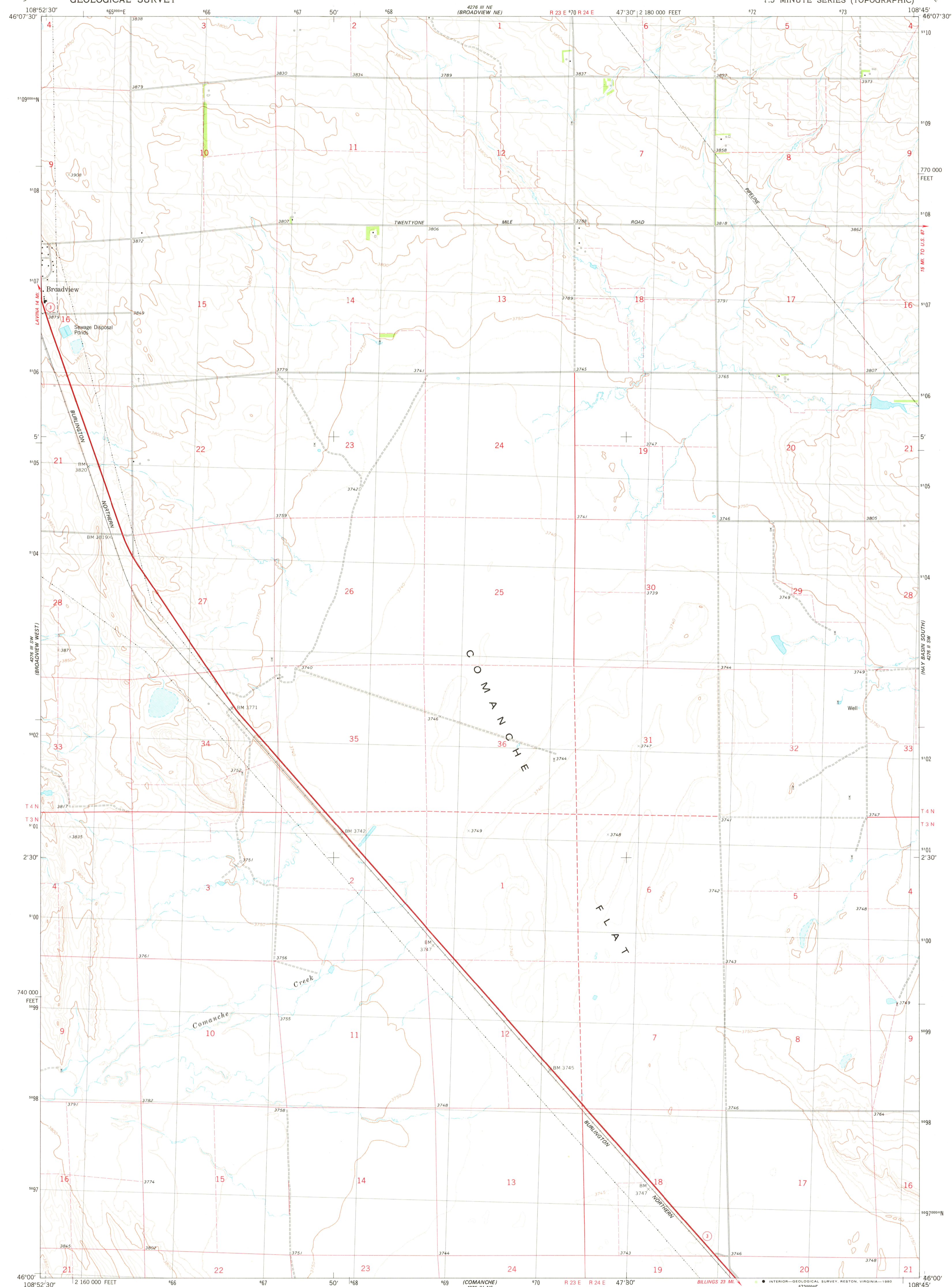

Mapped, edited, and published by the Geological Survey

Control by USGS and NOS/NOAA

Topography by photogrammetric methods from aerial photographs taken 1973. Field checked 1974. Map edited 1979

Projection and 10,000-foot grid ticks: Montana coordinate system, south zone (Lambert conformal conic) 1000-meter Universal Transverse Mercator grid, zone 12 1927 North American datum

To place on the predicted North American Datum 1983 move the projection lines 8 meters north and 55 meters east as shown by dashed corner ticks

Land lines, in part, are based on cultural development and are not reflected in the original land survey

Fine red dashed lines indicate selected fence lines

SCALE 1:24 000

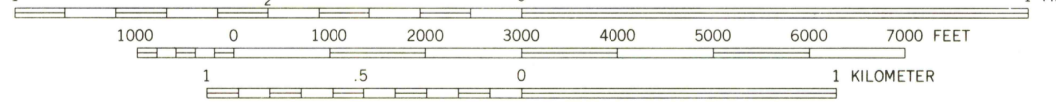

CONTOUR INTERVAL 10 FEET  
DOTTED LINES REPRESENT 5-FOOT CONTOURS  
NATIONAL GEODETIC VERTICAL DATUM OF 1929

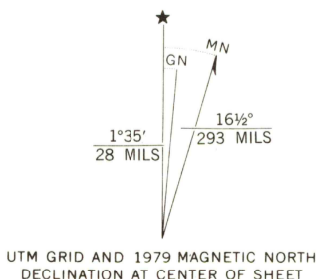

ROAD CLASSIFICATION

Primary highway, hard surface	Light-duty road, hard or improved surface
Secondary highway, hard surface	Unimproved road
Interstate Route	U. S. Route
	State Route



BROADVIEW EAST, MONT.  
N4600-W10845/7.5

1979

DMA 4276 III SE-SERIES V894