

WATFORD CITY, NW  
5379 IV NW  
5379 I NW

UNITED STATES  
DEPARTMENT OF THE INTERIOR  
GEOLOGICAL SURVEY



WATFORD CITY QUADRANGLE  
NORTH DAKOTA—MC KENZIE CO.  
7.5 MINUTE SERIES (TOPOGRAPHIC)

5379 I NW  
5379 I NW  
TIMBER HOOK CREEK

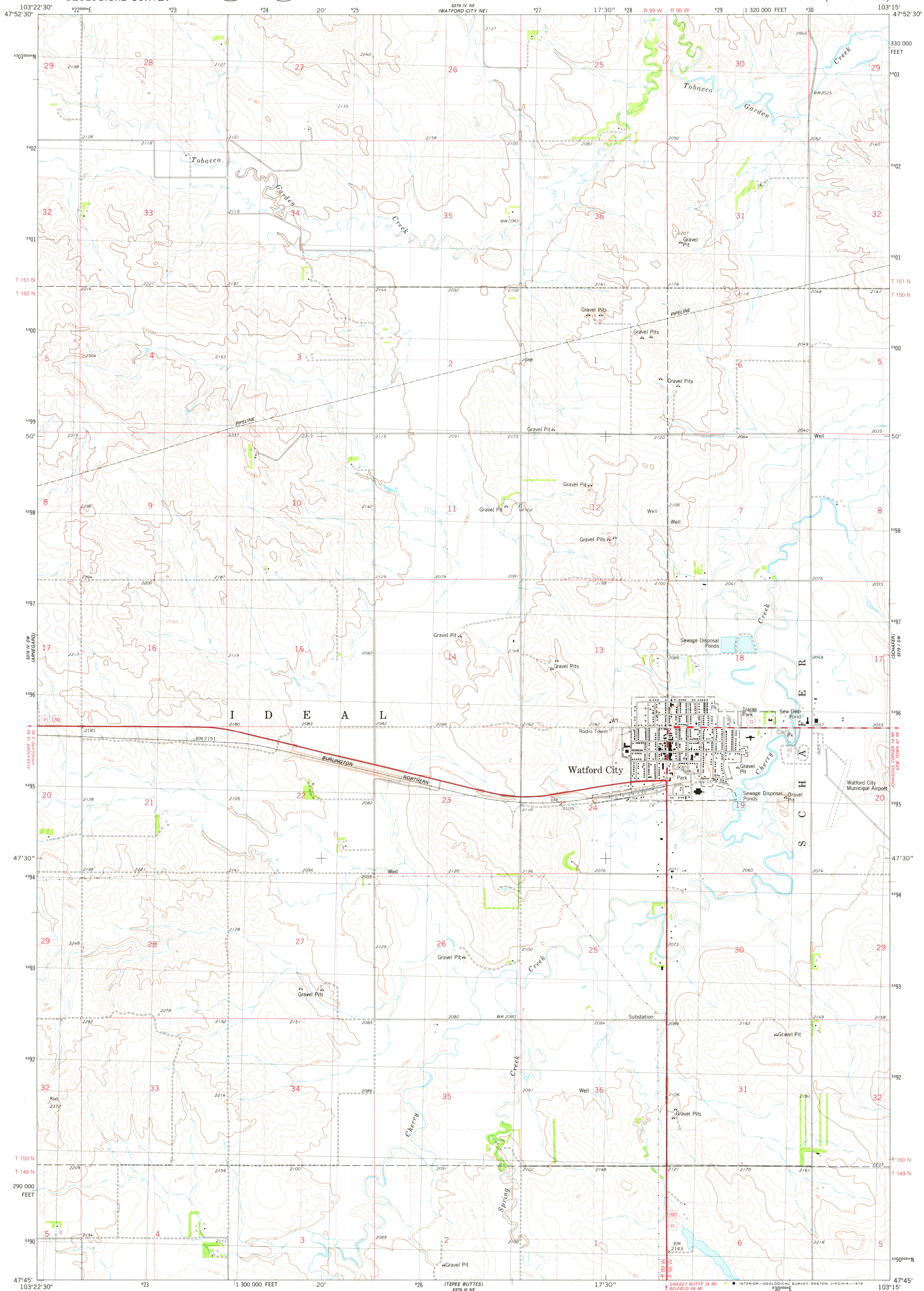

ISTOCK BUTTE  
5379 I NW

Mapped, edited, and published by the Geological Survey  
Control by USGS and NOS/NOAA  
Topography by photogrammetric methods from aerial photographs  
taken 1973. Field checked 1975. Map edited 1978  
Projection and 10,000-foot grid ticks: North Dakota coordinate  
system, north zone (Lambert conformal conic)  
1000-meter Universal Transverse Mercator grid, zone 13  
1927 North American datum  
Fine red dashed lines indicate selected fence and field lines where  
generally visible on aerial photographs  
This information is unchecked

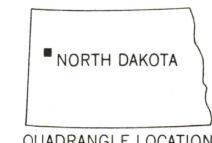
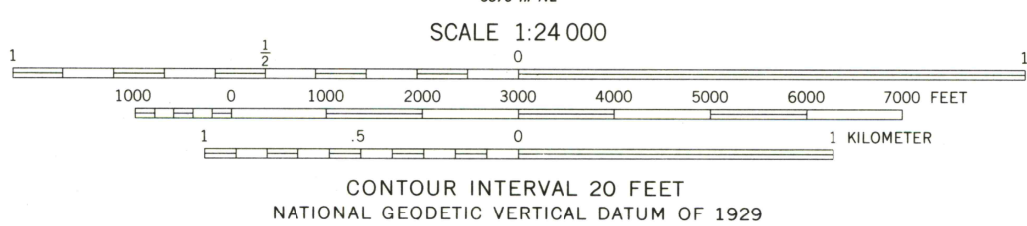
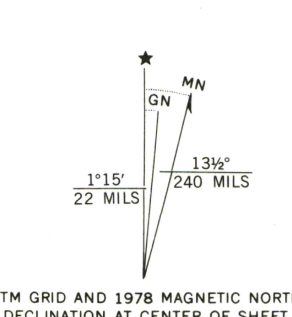

ROAD CLASSIFICATION  
Primary highway, hard surface  
Secondary highway, hard surface  
Unimproved road  
Interstate Route  
U. S. Route  
State Route  
Light-duty road, hard or improved surface  
Unimproved road

WATFORD CITY, N. DAK.  
N4745—W10315/7.5

1978

AMS 5379 IV SE—SERIES V871

THIS MAP COMPLIES WITH NATIONAL MAP ACCURACY STANDARDS  
FOR SALE BY U. S. GEOLOGICAL SURVEY, DENVER, COLORADO 80225, OR RESTON, VIRGINIA 22092  
AND STATE WATER COMMISSION, BISMARCK, NORTH DAKOTA 58501  
A FOLDER DESCRIBING TOPOGRAPHIC MAPS AND SYMBOLS IS AVAILABLE ON REQUEST