



U.S.G.S.  
FILE COPY  
Inspection and Editing

U.S.G.S.  
FILE COPY  
Inspection and Editing

A.M.S. V853 Type C (AMS 1), 1946.  
Prepared under the direction of the Chief of Engineers by the Army Map Service (TV), U. S. Army, Washington, D. C. Compiled in 1946 by USGS and TVA from aerial photography by stereophotogrammetric methods, by reference to Fort Knox Site Plans, 1:2400 and 1:4800, office of the Post Engineers, 1946; Kentucky, 1:10,000 Corps of Engineers, Special Military Map, Artillery Range Sheets 1, 2, 3, 4. Aerial photography for TVA, 1944-1945. Horizontal and vertical control by the USGS and USGS. Map field checked 1946. This map complies with the national standard map accuracy requirements.

**LEGEND**

**ROAD DATA 1945**

Hard surface, heavy duty road, more than two lanes wide  
Hard surface, heavy duty road, two lanes wide  
Secondary, hard surface, all-weather road  
Two lanes wide, State route marker

**RAILROADS**

Standard gauge  
Narrow gauge  
Single track carline

**BOUNDARIES**

International  
State  
County (with monument)  
County subdivision  
Military reservation  
School, Church  
Cemetery  
Churchyard

**UNDER CONSTRUCTION**

Single track  
Double track  
Double track carline

**ABANDONED**

Single track  
Double track  
Double track carline

**Other Features**

Mine  
Intermittent lake  
Intermittent stream  
Dam  
Spot elevation  
Large rapids and falls  
Swamp, marsh  
Rocks, wash at low tide  
Wharf, pier  
Man-made shoreline

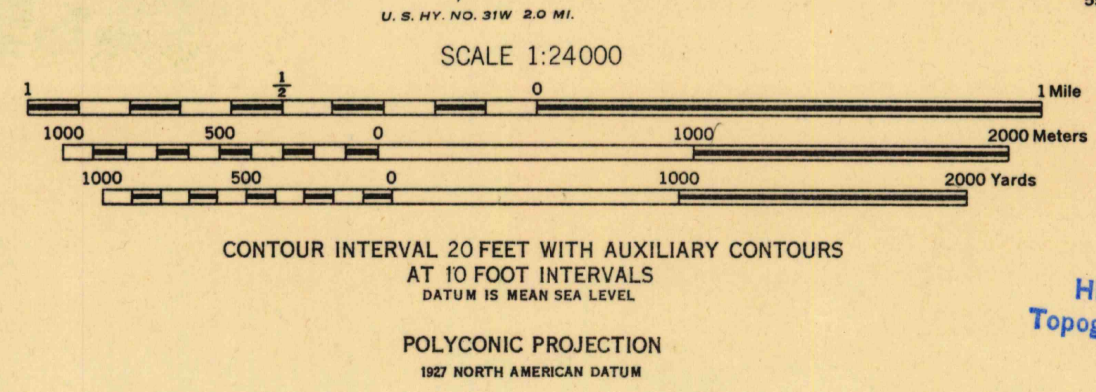

REPRINTED FROM MILITARY EDITION FOR CIVIL USE  
PENDING REVISION FOR STANDARD ISSUE  
SOLD AND DISTRIBUTED BY U. S. GEOLOGICAL SURVEY, WASHINGTON 25, D. C.

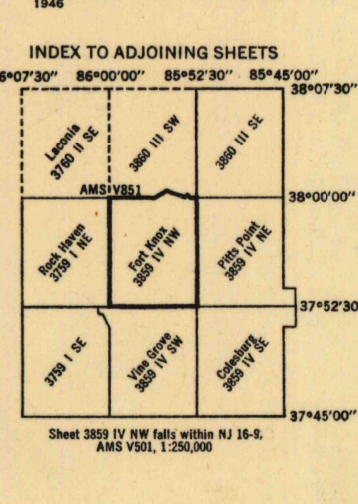
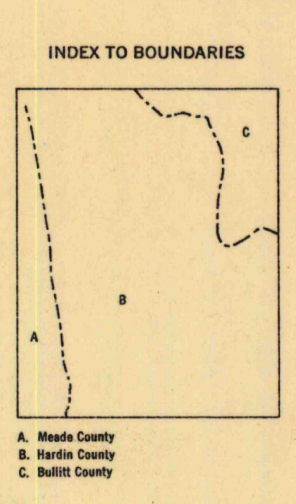
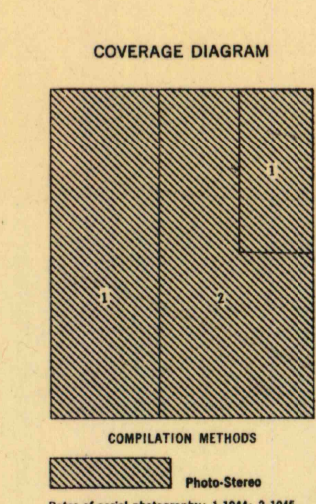

USGS  
Historical File  
Topographic Division

U.S.G.S.  
FILE COPY  
Inspection and Editing

FORT KNOX, KENTUCKY  
N3752.5-W8552.5/7.5

NOV 22 1948  
2155