

DEPARTMENT OF THE INTERIOR
U. S. GEOLOGICAL SURVEY

MONROE COUNTY, NEW YORK
REGIONAL PLANNING BOARD
DONALD S. BARROWS, CHAIRMAN, HAROLD G. DOBSON, VICE CHAIRMAN
ANDREW H. BOWN, ESTEN A. FLETCHER, FRANK W. MOFFETT
J. FRANKLIN BONNER, SECRETARY
ROY P. WARREN, ENGINEER

NEW YORK
(MONROE COUNTY)
RUSH QUADRANGLE

Advance sheet
Subject to correction

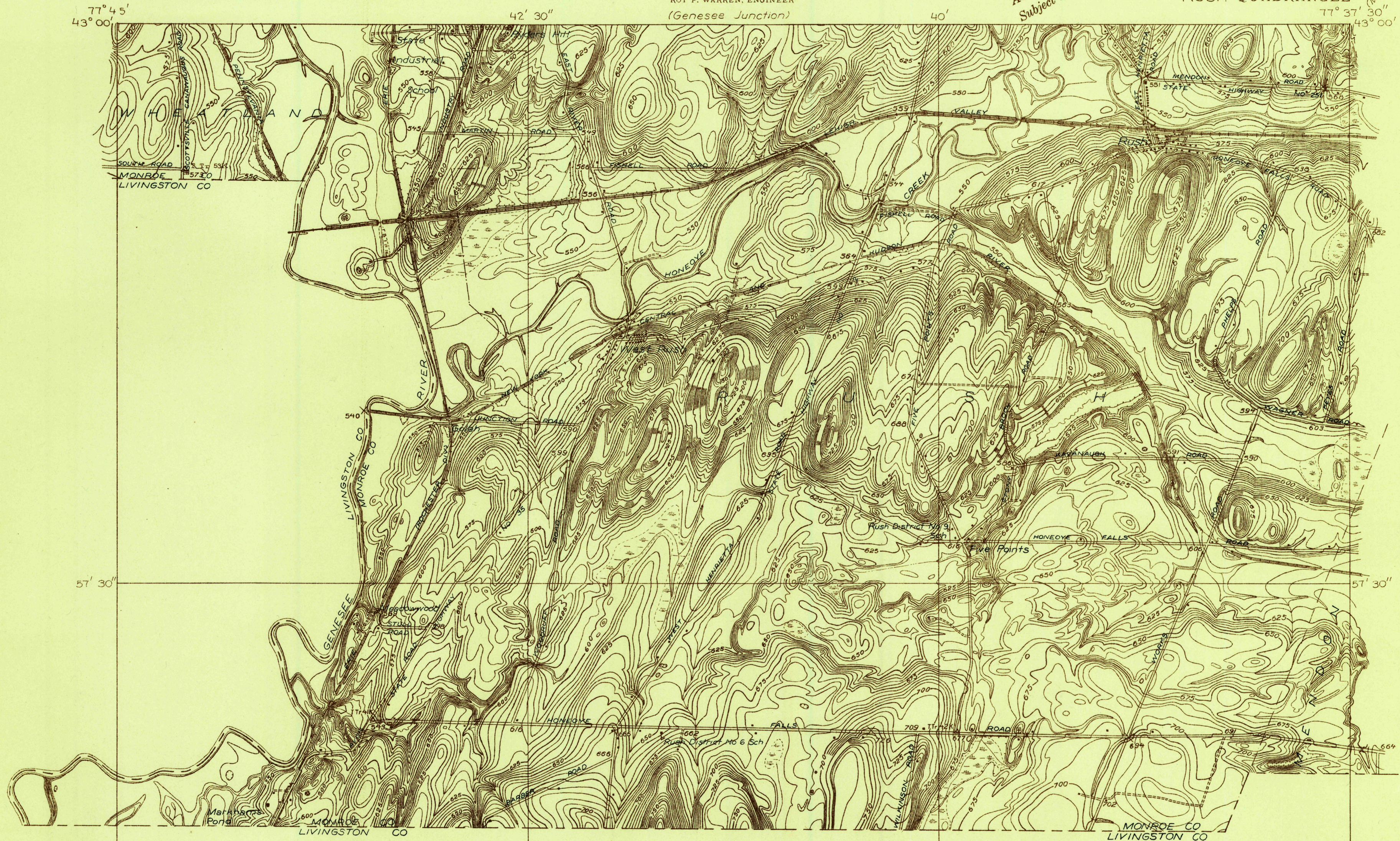

42° 56' 15"
77° 45'

Albert Pike, Division Engineer
Topography by H.F. Ewing
Culture and drainage in part compiled from aerial photographs
Control by U. S. Geological Survey and
U. S. Lake Survey
Surveyed in 1931

92°
TRUE NORTH
MAGNETIC NORTH
APPROXIMATE MEAN
DECLINATION, 1931

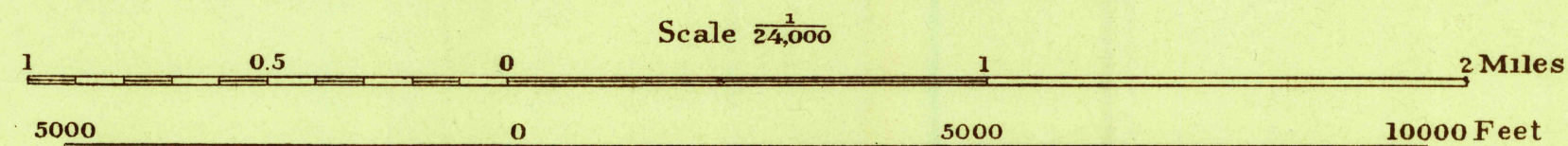

Contour interval 5 feet
Datum is mean sea level

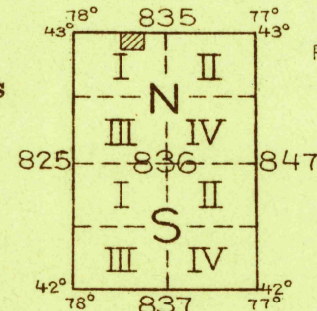

Polyconic projection North American datum

HISTORICAL FILES

(DO NOT REMOVE)

RUSH, N. Y.

USGS Library
Reston, VA.
Topo Archive