

DEPARTMENT OF THE INTERIOR  
FRANKLIN K. LANE, SECRETARY  
U. S. GEOLOGICAL SURVEY  
GEORGE OTIS SMITH, DIRECTOR

# TOPOGRAPHY

HARRIS COUNTY, TEXAS

W. H. WARD, COUNTY JUDGE

W. H. LLOYD, J. A. SMITH, W. H. KISER, D. BARKER  
COUNTY COMMISSIONERS

Advance sheet.  
Subject to correction.

INSPECTION FILES  
TOPOGRAPHY.

TEXAS  
(HARRIS COUNTY)  
CLODINE QUADRANGLE

(Milendah)

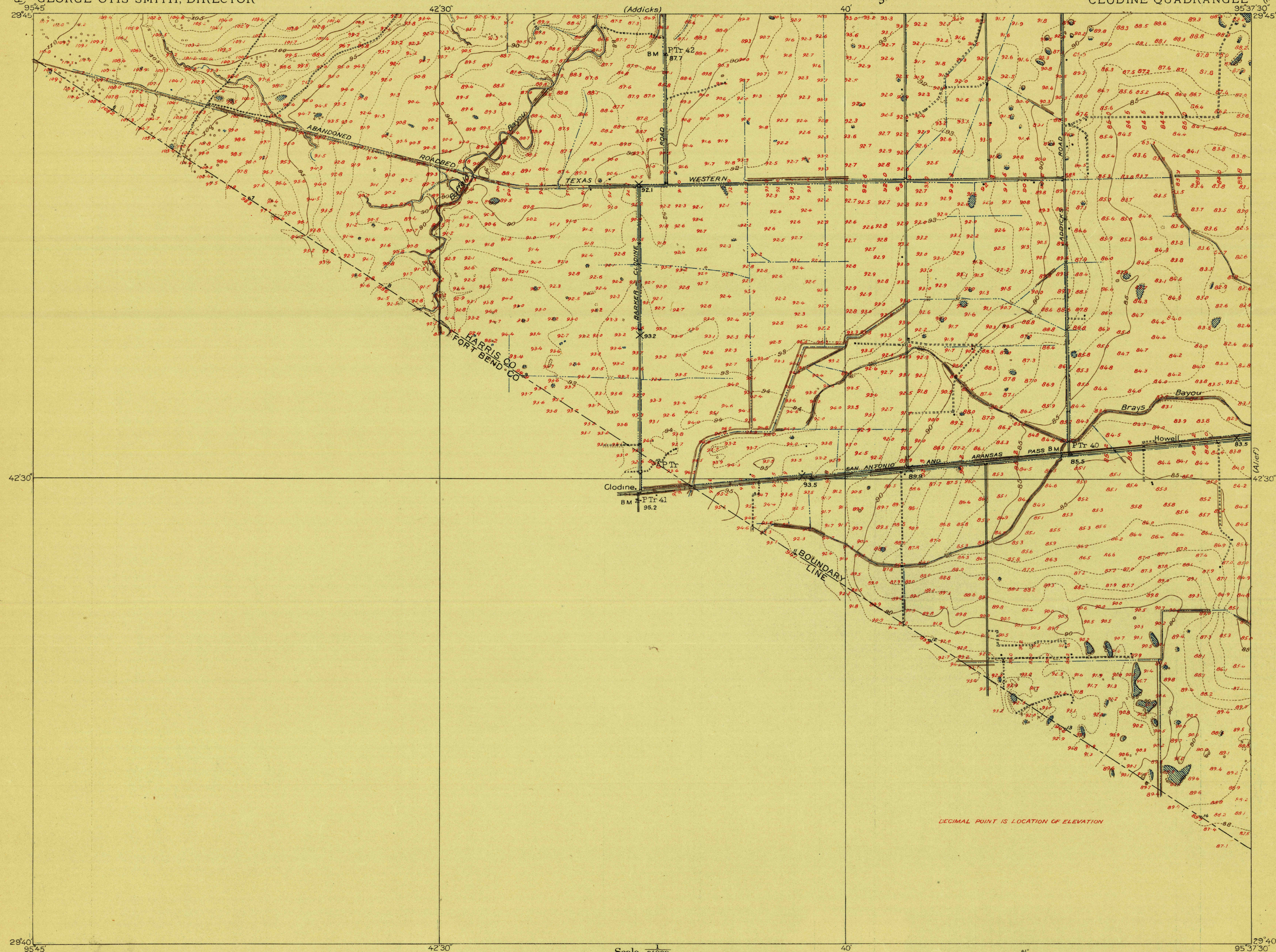

29°40'

42°30'

40'

29°40'

95°37'30"

R. B. Marshall, Chief Geographer  
Sledge Tatum, Geographer in charge  
Topography by W. B. Lewis and F. A. Danforth  
Control by E. L. McNair and R. R. Monbeck.

Surveyed in 1915

SURVEYED IN COOPERATION WITH HARRIS COUNTY, TEXAS

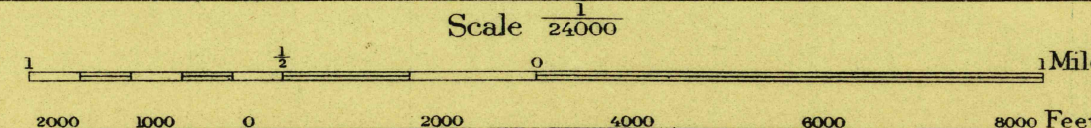
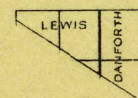

Contour interval 1 foot

TRUE NORTH  
MAGNETIC NORTH  
APPROXIMATE MEAN  
DECLINATION 1915

USGS  
Historical File  
Topographic Division

CLODINE, TEX.

RETURN TO:  
USGS AND HISTORICAL MAP ARCHIVES