

(Crystal City)  
62500

U.S.G.S.  
FILE COPY  
TOPOGRAPHIC DIVISION



Glenn S. Smith, Division Engineer  
Topography by Frank W. Hughes, J. A. Duck, S. B. O'Hara,  
W. A. Tingey, T. W. Ranta, Jos. H. Taubr, T. V. Cummings and F. W. Weber:  
Culture and drainage in part compiled from aerial photographs  
taken by Air Corps, U. S. Army  
Control by U. S. Geological Survey  
Surveyed in 1930-31



TRUE NORTH  
5%  
MAGNETIC NORTH

APPROXIMATE  
DECLINATION

Scale  $\frac{1}{24,000}$

Contour interval 20 feet

10 foot contours added in dashed lines

Datum is mean sea level

INTERIOR—GEOLOGICAL SURVEY, WASHINGTON, D. C.—1951

Polyconic projection. North American datum.  
660 000 yard grid based upon U. S. zone system. C

USCS  
Historical File  
Topographic Division

U.S.G.S.  
FILE COPY  
TOPOGRAPHIC DIVISION

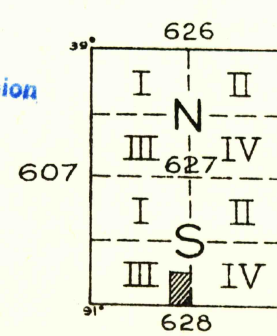

DE SOTO MO  
S.E. 1/4

JAN 10 1955