

5800' N
100°52'30"

UNITED STATES
DEPARTMENT OF THE INTERIOR
GEOLOGICAL SURVEY

STATE OF KANSAS

TENNIS QUADRANGLE
KANSAS—FINNEY CO.
7.5 MINUTE SERIES (TOPOGRAPHIC)

5800' N
100°52'30"

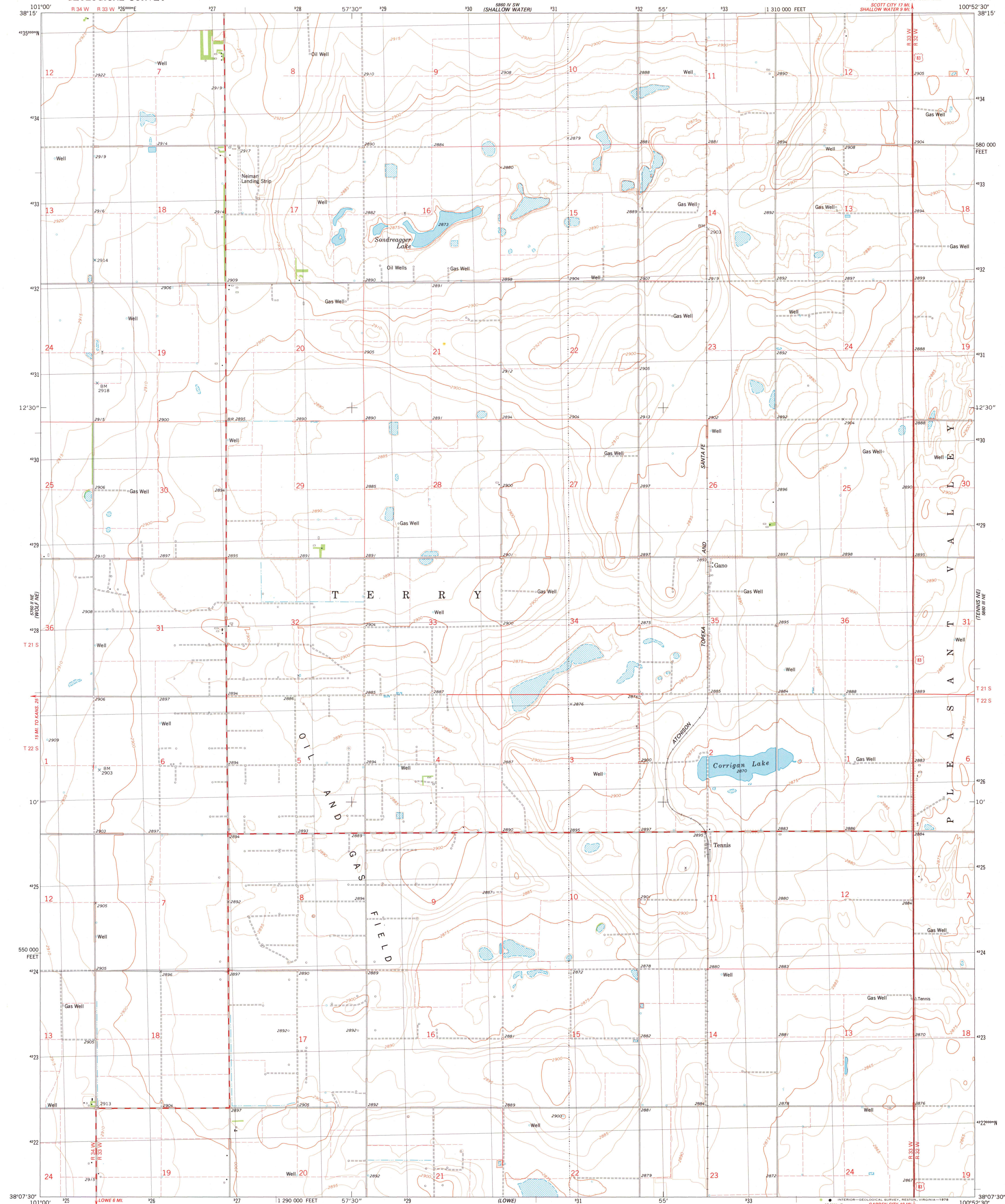

Mapped, edited, and published by the Geological Survey
in cooperation with State of Kansas agencies
Control by USGS and NOS/NOAA
Topography by photogrammetric methods from aerial
photographs taken 1974. Field checked 1976
Projection and 10,000-foot grid ticks: Kansas coordinate
system, south zone (Lambert conformal conic)
1000-meter Universal Transverse Mercator grid, zone 14
1927 North American datum
Fine red dashed lines indicate selected fence and field lines where
generally visible on aerial photographs. This information is unchecked

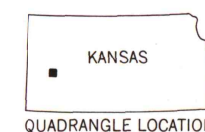
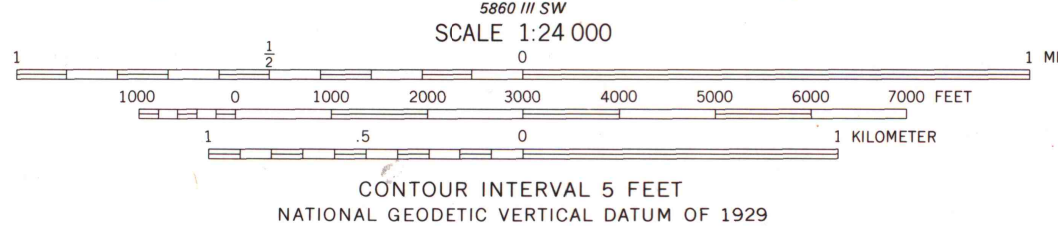
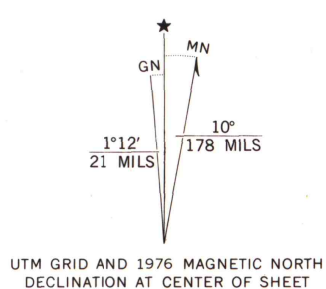

Primary highway, hard surface
Secondary highway, hard surface
Light-duty road, hard or improved surface
Unimproved road
Interstate Route
U. S. Route
State Route

MAP AND AIR PHOTO
LIBRARY

JUN 19 1978

University of Wisconsin
Madison

TENNIS, KANS.
NW/4 TENNIS 15' QUADRANGLE
N3807.5—W10052.5/7.5

1976

AMS 5800 III NW—SERIES Y878