

UNITED STATES  
DEPARTMENT OF THE INTERIOR  
GEOLOGICAL SURVEY

STONINGTON SE QUADRANGLE  
COLORADO—KANSAS  
7.5 MINUTE SERIES (TOPOGRAPHIC)

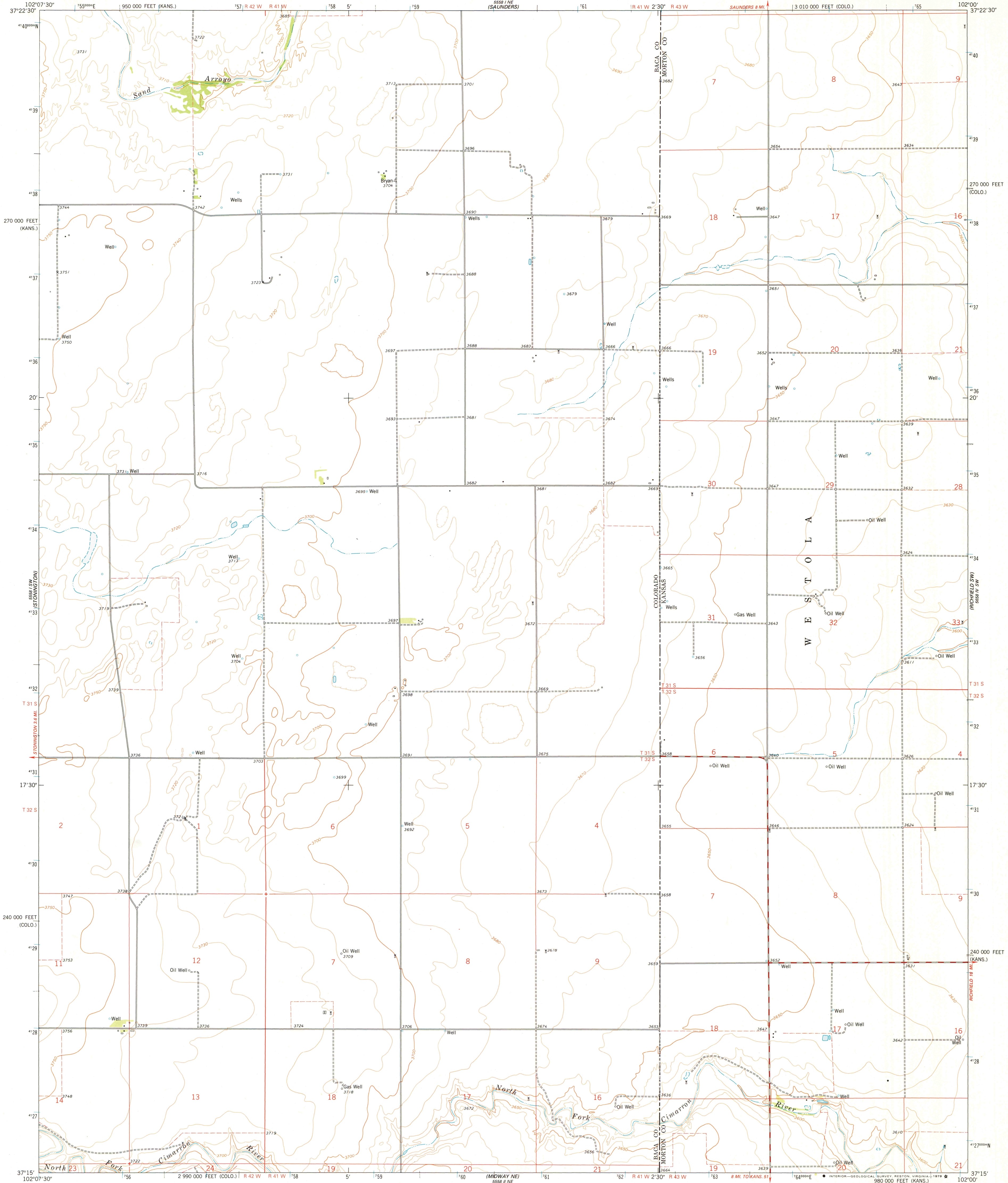

Mapped, edited, and published by the Geological Survey  
Control by USGS and NOS/NOAA

Topography by photogrammetric methods from aerial photographs  
taken 1973. Field checked 1974. Map edited 1978  
Projection: Colorado coordinate system, south zone  
(Lambert conformal conic)  
10,000-foot grid ticks based on Colorado coordinate system,  
south zone and Kansas coordinate system, south zone  
1000-meter Universal Transverse Mercator grid ticks,  
zone 13, shown in blue. 1927 North American datum  
Fine red dashed lines indicate selected fence lines  
Land lines are omitted in areas of extensive tract surveys

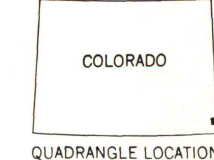
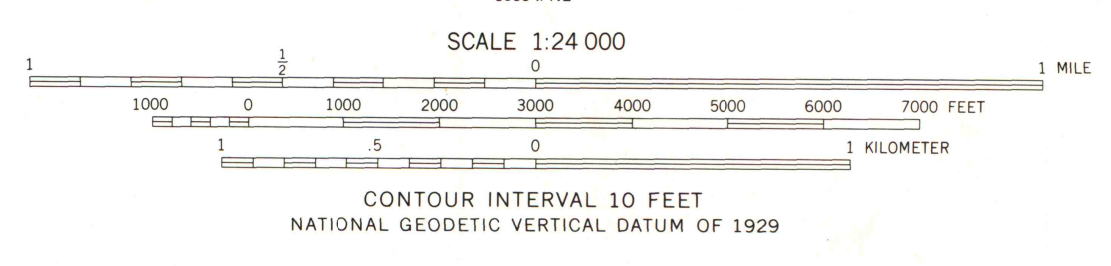
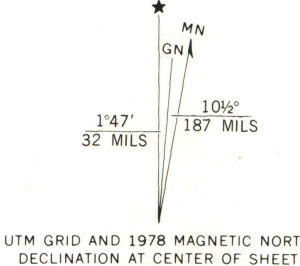

ROAD CLASSIFICATION  
Primary highway, hard surface ——— Light-duty road, hard or improved surface ———  
Secondary highway, hard surface ——— Unimproved road ———  
Interstate Route ——— U. S. Route ——— State Route ———

STONINGTON SE, COLO.—KANS. JUN 26 1979  
N3715—W10200/7.5

1978  
AMS 5558 I SE—SERIES V877  
University of Wisconsin  
Madison