

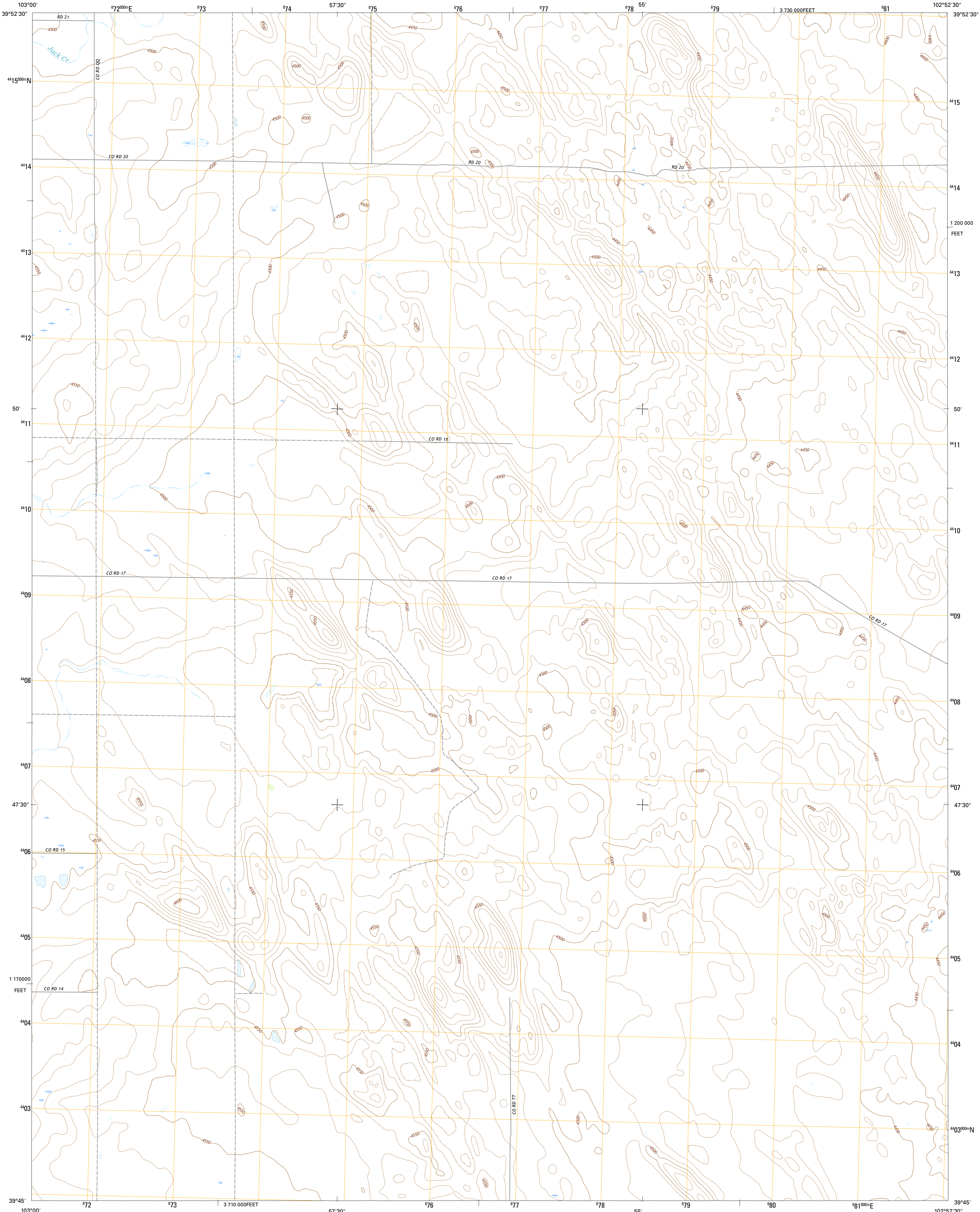

U.S. DEPARTMENT OF THE INTERIOR
U.S. GEOLOGICAL SURVEY



DE NOVA QUADRANGLE
COLORADO-WASHINGTON CO.
7.5-MINUTE SERIES



Produced by the United States Geological Survey
North American Datum of 1983 (NAD83)
Roads..... U.S. Census Bureau, 2015 - 2016
Names..... U.S. Census Bureau, 2015 - 2016
Hydrography..... National Hydrography Dataset, 2013
Contours..... National Elevation Dataset, 2007
Boundaries..... Multiple sources; see metadata file 1972 - 2016
Public Land Survey System..... BLM, 2011
Wetlands..... FWS National Wetlands Inventory 1977 - 2014

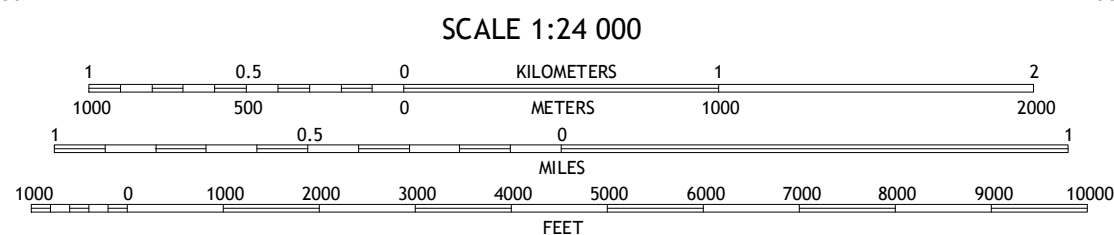
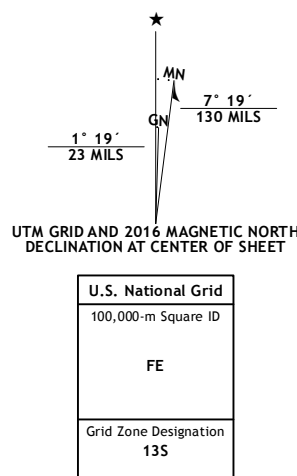

CONTOUR INTERVAL 10 FEET
NORTH AMERICAN VERTICAL DATUM OF 1988
This map was produced to conform with the
National Geospatial Program US Topo Product Standard, 2011.
A metadata file associated with this product is draft version 0.6.19

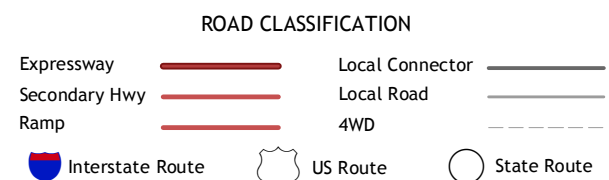
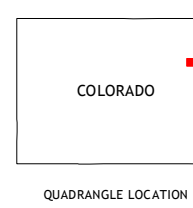

1	2	3
4	5	6
7	8	9

1 Elba NE
2 De Nova NW
3 De Nova NE
4 Elba SE
5 De Nova SE
6 Arickaree
7 Cope NW
8 Cope

DE NOVA, CO
2016

